

TECHNICAL SPECIFICATIONS

ISP Process Pumps - ISP350-500 (400-350-500)

ISP Impeller 283929 CLOSED B85 Z6

Performance Curve - ISP350-500-C-740

740 rpm

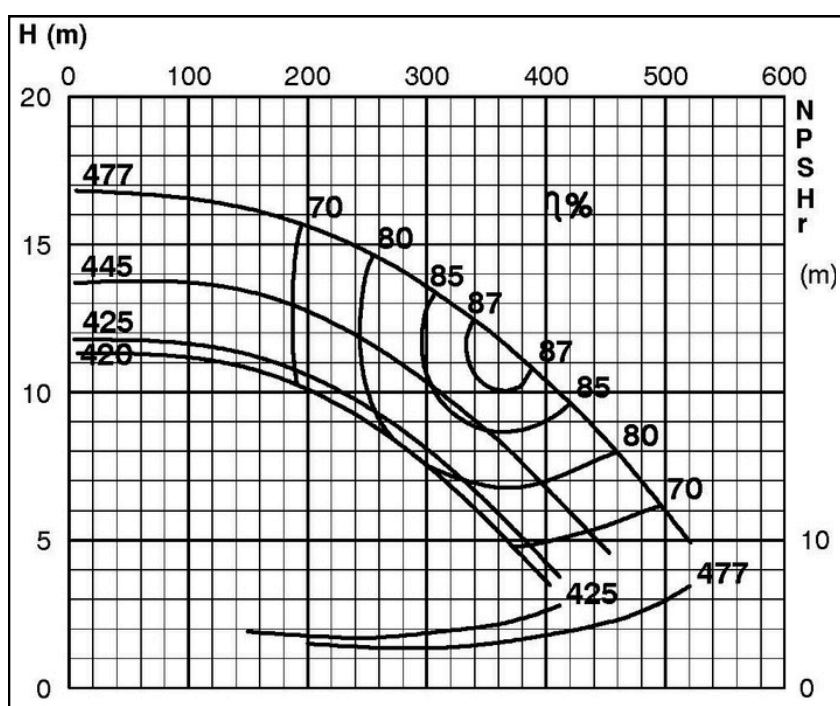

IMPELLER DIA			
$\varnothing d_2$ (mm)	K°	$\varnothing d_a$ (mm)	$\varnothing d_b$ (mm)
477	13	439	432.4
475	13	436	432.4
470	13	431	
465	13	426	
460	13	421	
455	14	412	
450	14	407	
445	15	398	
440	16	389	
435	17	380	
430	18	371	
425	19	362	
420	20	353	

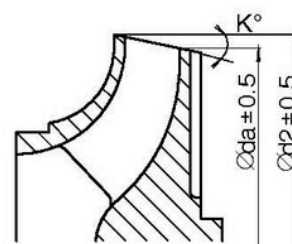
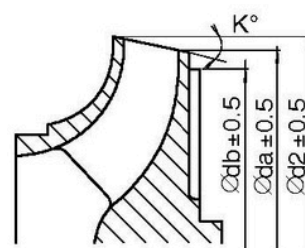
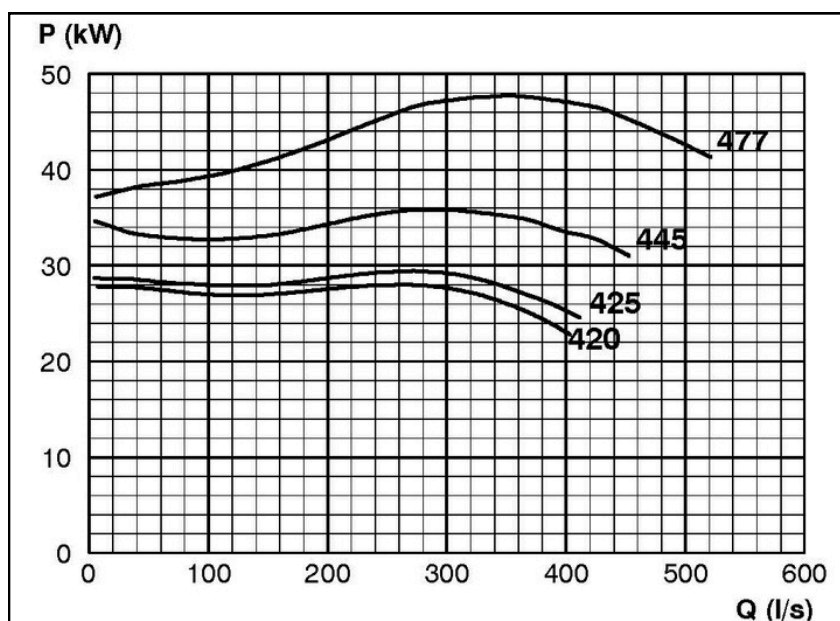

RET14153