

## TECHNICAL SPECIFICATIONS

ISP Process Pumps - ISP300-315 (350-300-315)

ISP Impeller 283924 CLOSED B72 Z6

### Performance Curve - ISP300-315-C-730

730 rpm

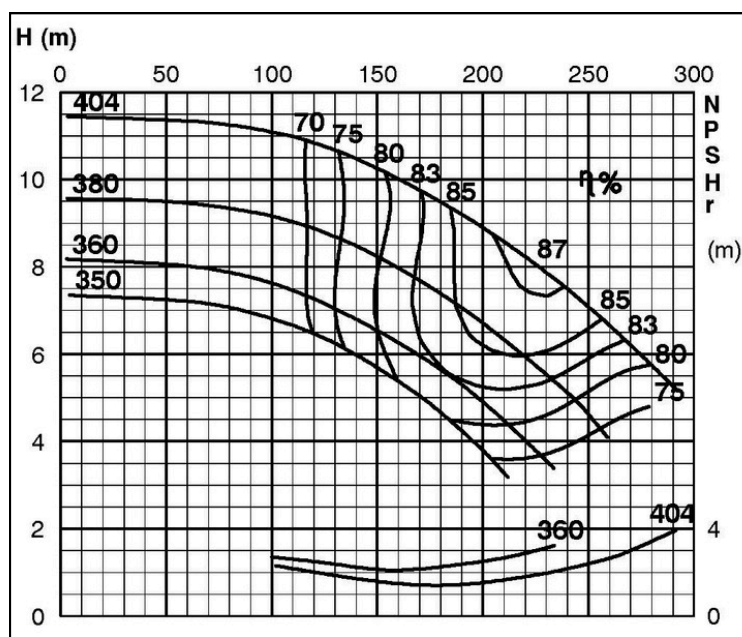

IMPELLER DIA			
$\varnothing d_2$ (mm)	K°	$\varnothing d_a$ (mm)	$\varnothing d_b$ (mm)
404	13	371.6	365.5
400	13	367.0	365.5
395	14	359.0	
390	14	354.0	
385	15	346.0	
380	16	338.0	
375	17	330.0	
370	18	322.0	
365	19	314.0	
360	20	305.0	
355	22	294.0	
350	24	282.0	

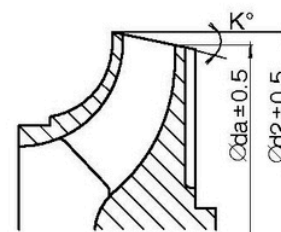
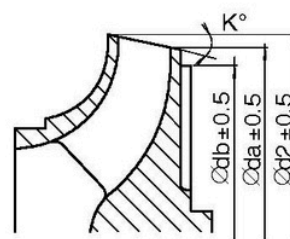
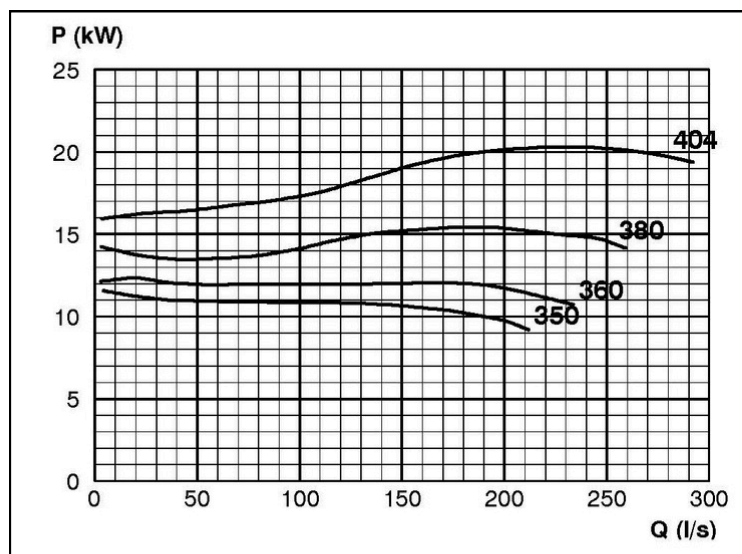

RET14148