

TECHNICAL SPECIFICATIONS

ISP Process Pumps - ISP250-315 (300-250-315)

ISP Impeller 283923 CLOSED B64 Z6

Performance Curve - ISP250-315-C-730

730 rpm

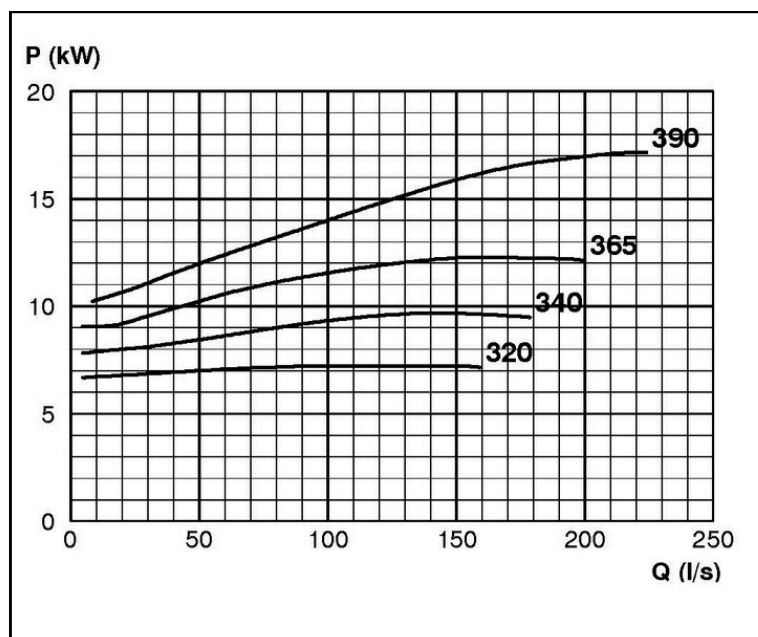
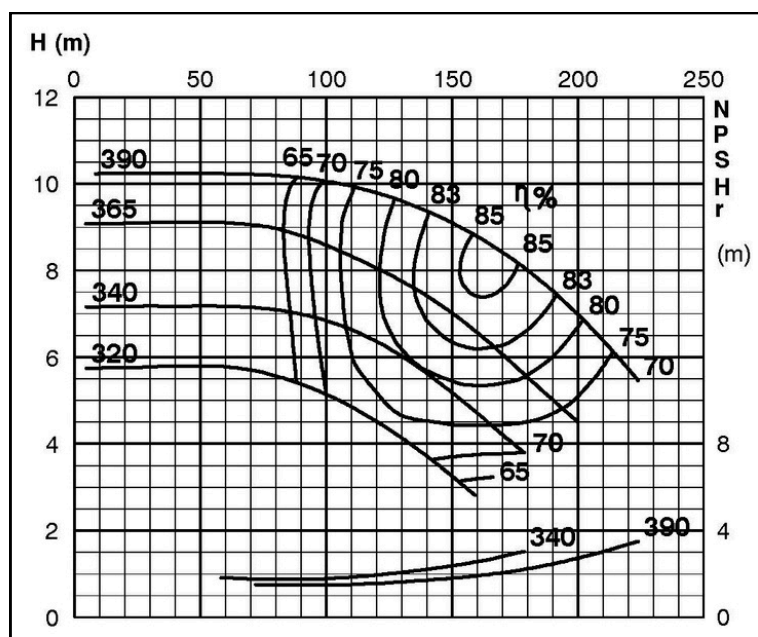

IMPELLER DIA			
Ød ₂ (mm)	K°	Ød _a (mm)	Ød _b (mm)
390	9	370	365.6
385	9	365	
380	10	357	
375	10	352	
370	11	344	
365	11	339	
360	12	331	
355	13	324	
350	14	316	
345	15	308	
340	16	300	
335	17	291	
330	18	283	
325	19	275	
320	20	266	

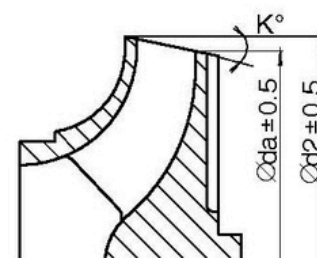
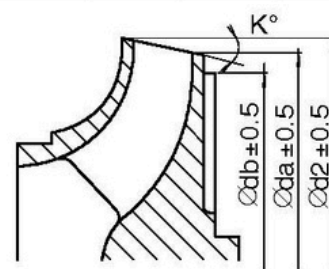

RET14147