

## TECHNICAL SPECIFICATIONS

ISP Process Pumps - ISP200-500 (250-200-500)

ISP Impeller 283932 CLOSED B35 Z6

Performance Curve - ISP200-500-C-740

740 rpm

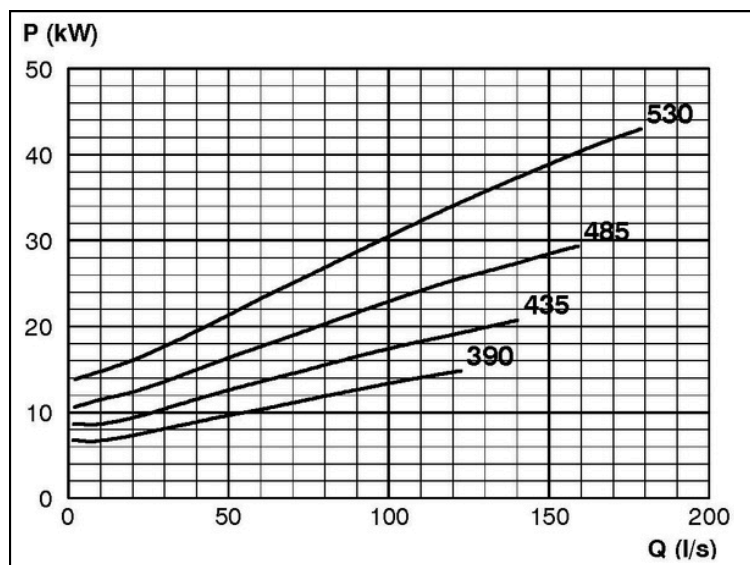
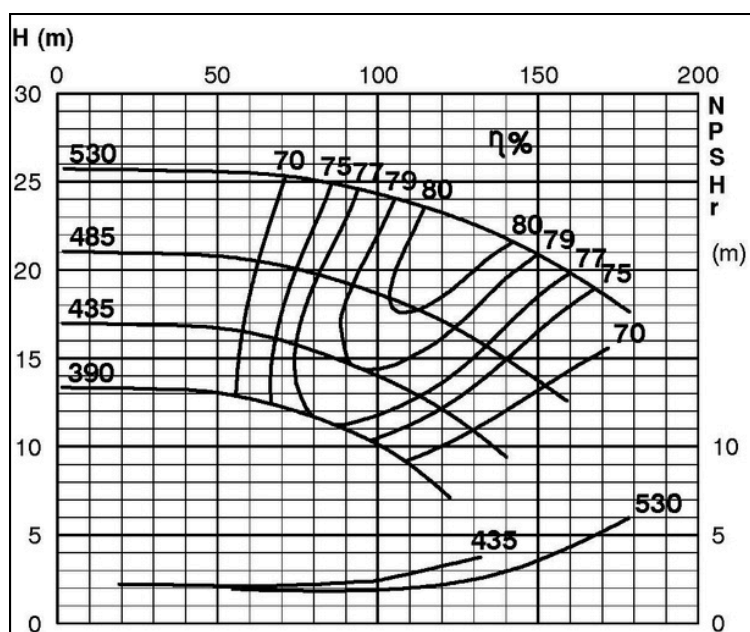

IMPELLER DIA	
Ød <sub>2</sub> (mm)	Ød <sub>b</sub> (mm)
530	465
525	462
520	459
515	456
510	452
505	449
500	446
495	443
490	440
485	438
480	435
475	432
470	429
465	427
460	424
455	421
450	418
445	416
440	414
435	412
430	410
425	408
420	406
415	404
410	402
405	400
400	398
395	395
390	390

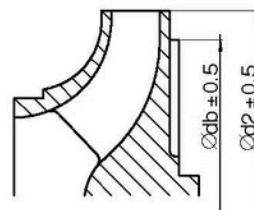

RET14157